

## WHAT'S INCLUDED

Orbit FLEX Arm Tank Mount INST-4491

Each Orbit Flex Arm Tank Mount includes:

Item	Description	Quantity
A	Flex Arm	1
B	Rimless Tank Mount Bracket	1
C	Tank Mount Screws	2
D	Flex Arm Bracket	1
F	Flex Arm Screws	4
G	Cable Wraps	1

### Note:

If your Orbit Flex Arm is missing any components, please contact us directly at [www.current-usa.com](http://www.current-usa.com).

DO NOT RETURN TO RETAILER

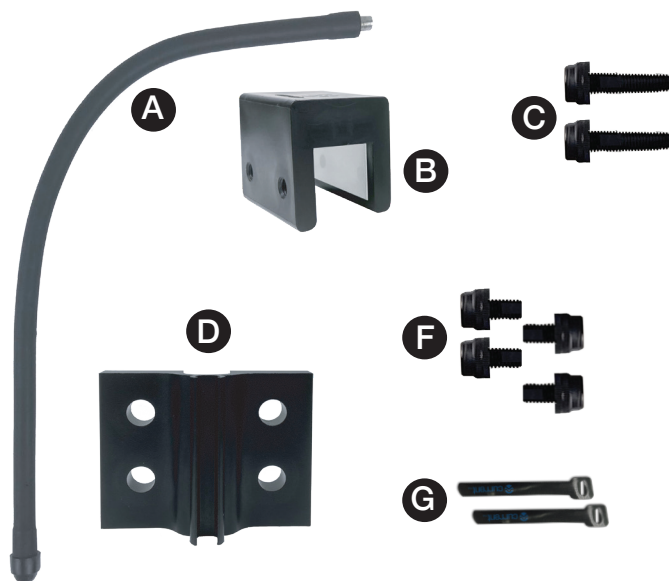

## BEFORE INSTALLATION



### IMPORTANT READ ALL SAFETY WARNINGS

This tank mount arm bracket is compatible only with Current-USA Orbit REEF LED.

Rimless tank bracket will only fit aquariums up to 1" thick or 1" plastic frame. DO NOT CUT AQUARIUM FRAME. For wider plastic frame or Euro-braced aquariums, use our Stand Mount Adapter Kit.

DO NOT PUSH, PULL or FULLY ROTATE flex arm while flex arm is attached to aquarium. Doing so can cause glass breakage.

ALWAYS disconnect light from power when performing tank maintenance.

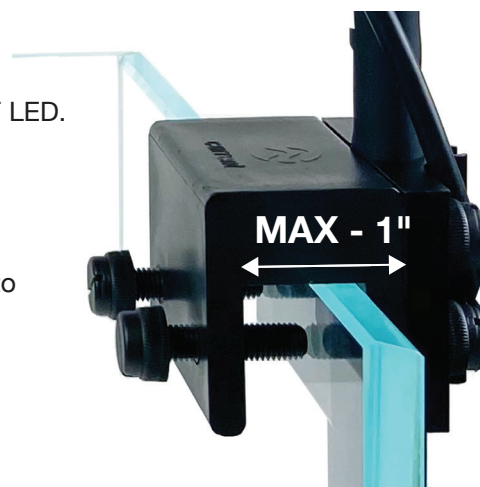

## INSTALLATION

### 1 UNPACK

Remove all items from packaging.

Ensure tank mount bracket will fit on aquarium by sliding over tank edge.

### 2 CLEAN

1. Determine location on tank where the tank arm bracket will be installed. Clean glass of any algae or debris and ensure a dry mounting surface for arm.
2. Place bracket on tank edge and ensure it fits before installation. If your tank has a plastic frame or is too wide, please purchase our optional stand mount adaptor kit.

### 3 ASSEMBLE

1. Straighten flex arm, then insert screw side of flex arm into back of REEF LED light and rotate to tighten. Hand tighten only.

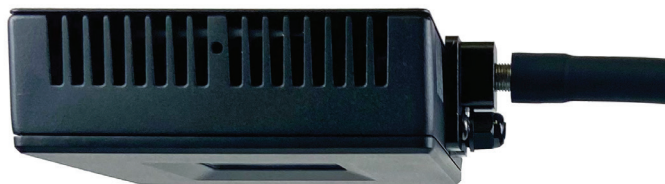

2. Bend arm down and attach slide the bracket back piece (4 holes) over arm. **\*\*Important - for the cleanest install, match the tank mount bracket to back piece and ensure both pieces are level at top.**

Ensure both brackets are level

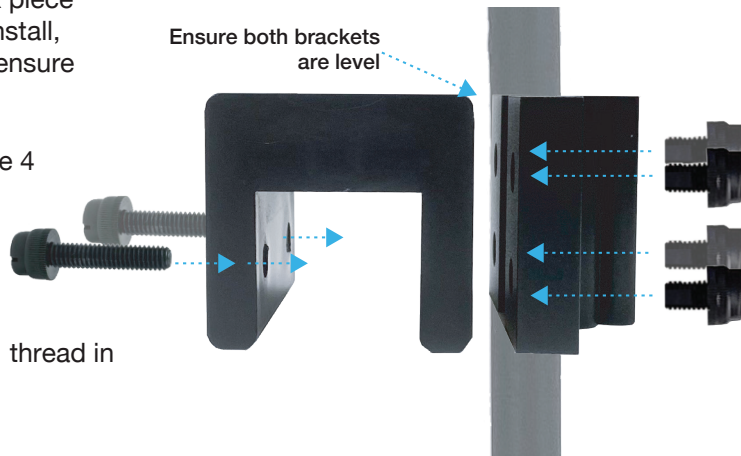

3. Attach back piece to tank mount bracket using the 4 small ABS screws. Hand tighten only.

4. Attach two longer front screws to front of bracket, thread in about 1/2 way.

5. Place bracket into position on tank edge and hand tighten front screws to attach to tank wall.

### 4 ADJUST & FINISH

1. Bend flex arm to position light over center of your reef.
2. Once vertical height and bend is adjusted, tighten back and front screws. (We recommend hand tightening only. IF a screwdriver must be used, use a large flat head to ensure the ABS screws are not stripped.)
3. To adjust light for cleaning, maintenance, aquascaping or other tank access requirements, lift light up vertically.
4. Slide light cable into the cable clasp on back bracket, use included Velcro straps to secure cable to arm and keep tidy.



For additional support, visit [www.current-usa.com](http://www.current-usa.com)

**SAVE THESE INSTRUCTIONS**

## SAFETY WARNINGS / DISCLAIMERS

**This is NOT a page of legalese. It contains important safety information that you should read and save for future reference. Remember you can always quickly access instructions for all our products at [www.current-usa.com](http://www.current-usa.com).**

- Never attempt repairs yourself; return the appliance to an authorized service facility for service or discard the appliance.
- Carefully examine the fixture after installation and BEFORE you plug it into the GFCI wall outlet. Be sure there is no water on any part of the light fixture or the timer.
- Never plug in a wet cord. If a plugged in unit or socket does get wet, DON'T touch it. Instead, promptly disconnect the fuse or circuit breaker that supplies power to the fixture. Then, you may unplug the fixture and examine for the presence of water.
- Never operate a fixture that is damaged or malfunctioning, discontinue use immediately and return the appliance to an authorized service facility.
- Close supervision is necessary when any appliance is used by or near children.
- Always unplug the fixture when not in use, before putting on or taking off parts, and before cleaning. Never pull the cord to unplug from the GFCI.
- Do not use the fixture for anything other than intended use. The use of attachments not recommended or sold by the fixture manufacturer may cause an unsafe condition and will void your warranty.
- Do not install or store the fixture where it will be exposed to the weather or to temperatures below 0° Celsius or 32° Fahrenheit.

- Do not operate at temperatures above 50° Celsius or 122° Fahrenheit.
- Ensure the fixture is securely installed before supplying power to the unit.
- Read and observe all the important notices and warnings on the fixture and power cord. **DO NOT REMOVE THE WARNING LABEL.**
- If an extension cord is necessary, a cord with a rating at least 15 amperes should be used. A cord rated for less amperes or watts than the fixture rating may overheat. Care should be taken to arrange the cord so that it will not be tripped over or pulled.
- Do not look directly into the LEDs.
- **This product MUST be powered by a UL or ETL listed power supply.**
- **To avoid possible electric shock, power supply MUST be plugged into a GFCI wall outlet installed by a certified electrician in accordance with all local codes. All products must have a drip loop.**

### Important Warnings | Drip Loops

Drip Loops should always be used to help prevent water from traveling along the cord and coming into contact with an electrical outlet. Drip loops must always be below the level of the outlet.

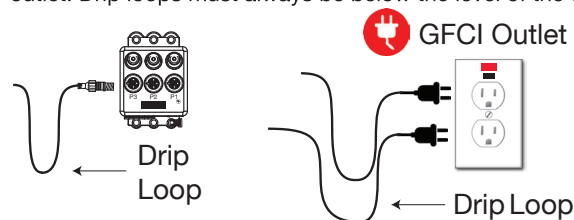

Register your product and find additional support at [www.current-usa.com](http://www.current-usa.com)

## SAVE THESE INSTRUCTIONS

## WARRANTY

**This product MUST be purchased from an authorized Current-USA reseller. Visit our website for a list of unauthorized resellers. Current USA, Inc. warrants this product against defects in materials and workmanship for ONE (1) YEAR from the date of original retail purchase and is none transferable.**

Warranty on all Products, including Aquariums, is limited to replacement of the product and does not cover fish loss, personal injury, property loss or direct, incidental or consequential damage arising from the use of this product.

Note: Current-USA, Inc. One-Year Limited Warranty does not cover damage caused by the following: improper installation, saltwater corrosion, electrical surges, or modifications.

If you discover a defect, please see your retail store or point of purchase. Current USA, Inc. will, at it's option, repair or replace the product at no charge to you, provided you return it during the warranty period. A copy of the bill of sale is required as proof of original purchase date in the event the product needs repairs within the warranty period. Please see your dealer for return options and warranty replacement parts. This warranty applies only to products by or for Current USA, Inc. that can be identified by trade name, or logo affixed to them. Current-USA, Inc. does not warrant any products that are not Current-USA, Inc..

This warranty does not apply if the product has been damaged by accident, abuse, misuse or misapplication or if the product has been modified without the written permission of Current-USA, Inc.; or if any Current-USA, Inc. logos have been removed or defaced.

THE WARRANTY AND REMEDIES SET FORTH ABOVE ARE EXCLUSIVE AND IN LIEU OF ALL OTHERS, WHETHER ORAL OR WRITTEN, EXPRESSED OR IMPLIED CURRENT USA, INC. SPECIFICALLY DISCLAIMS ANY AND ALL IMPLIED WARRANTIES, INCLUDING BUT NOT LIMITED TO LOST PROFITS, DOWNTIME, GOODWILL, DAMAGE TO OR REPLACEMENT OF EQUIPMENT AND PROPERTY, AND ANY COSTS OF RECOVERING ANIMALS, PLANTS, TANKS OR OTHER AQUARIUM RELATED ITEMS AND/OR EQUIPMENT. CURRENT USA, INC. IS NOT RESPONSIBLE FOR SPECIAL, INCIDENTAL, OR CONSEQUENTIAL DAMAGES RESULTING FROM ANY BREACH OF WARRANTY, OR REPLACEMENT OF EQUIPMENT OR PROPERTY, OR ANY COSTS OF RECOVERING OR REPRODUCING ANY EQUIPMENT, ANIMALS OR PLANTS USED OR GROWN WITH CURRENT USA, INC. PRODUCTS. Some jurisdictions do not allow the exclusion or limitation of incidental or consequential damages or exclusions of implied warranties, so the above limitations or exclusions may not apply to you. This warranty gives you specific legal rights, and you may also have other rights that vary from jurisdiction to jurisdiction.